

Amadeus Diamond

One of Europe's Finest French Balcony Ships

Your Suite is your spacious home away from home, containing all the refinements of a luxury 5-star hotel. Every cabin is equipped with hotel-style beds (they can be kept separate or put together as you wish), private ensuite bathroom, air conditioning (individually adjustable), TV, Infotainment and a sitting area with a table and chairs. All cabins on the Mozart and Strauss decks have large French balconies with floor-to-ceiling windows that stretch across the whole cabin. Cabins on the Haydn deck have fixed windows.



Luxury Owners Suites

For an extra touch of luxury and the ultimate in cruising indulgence, try one of our owners suites, with space rarely found on other ships. Measuring up to 236 sq.ft (22sq.m), the Owner's Suites represent the ultimate in spaciousness. The extra floor space is a benefit and it means that your Suite contains all the luxuries of a French Balcony stateroom and a lot more.

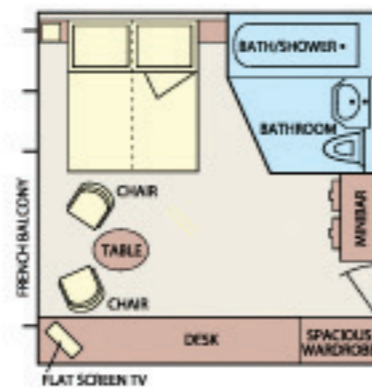

French Balcony Stateroom

Measuring up to 161 sq. ft (15sq.m), our all-weather French Balcony staterooms (83% of cabins) are located on the Strauss and Mozart Decks and offer exceptional comfort and the undeniable appeal of unimpeded views to the ever-changing landscapes of Europe.



Standard Stateroom

Measuring up to 161 sq. ft (15sq.m), the standard staterooms are located on the Haydn Deck. Though the cabin size and interior fixtures are identical to the French balcony stateroom, the difference is in the windows, as all Standard staterooms have fixed windows (do not open).

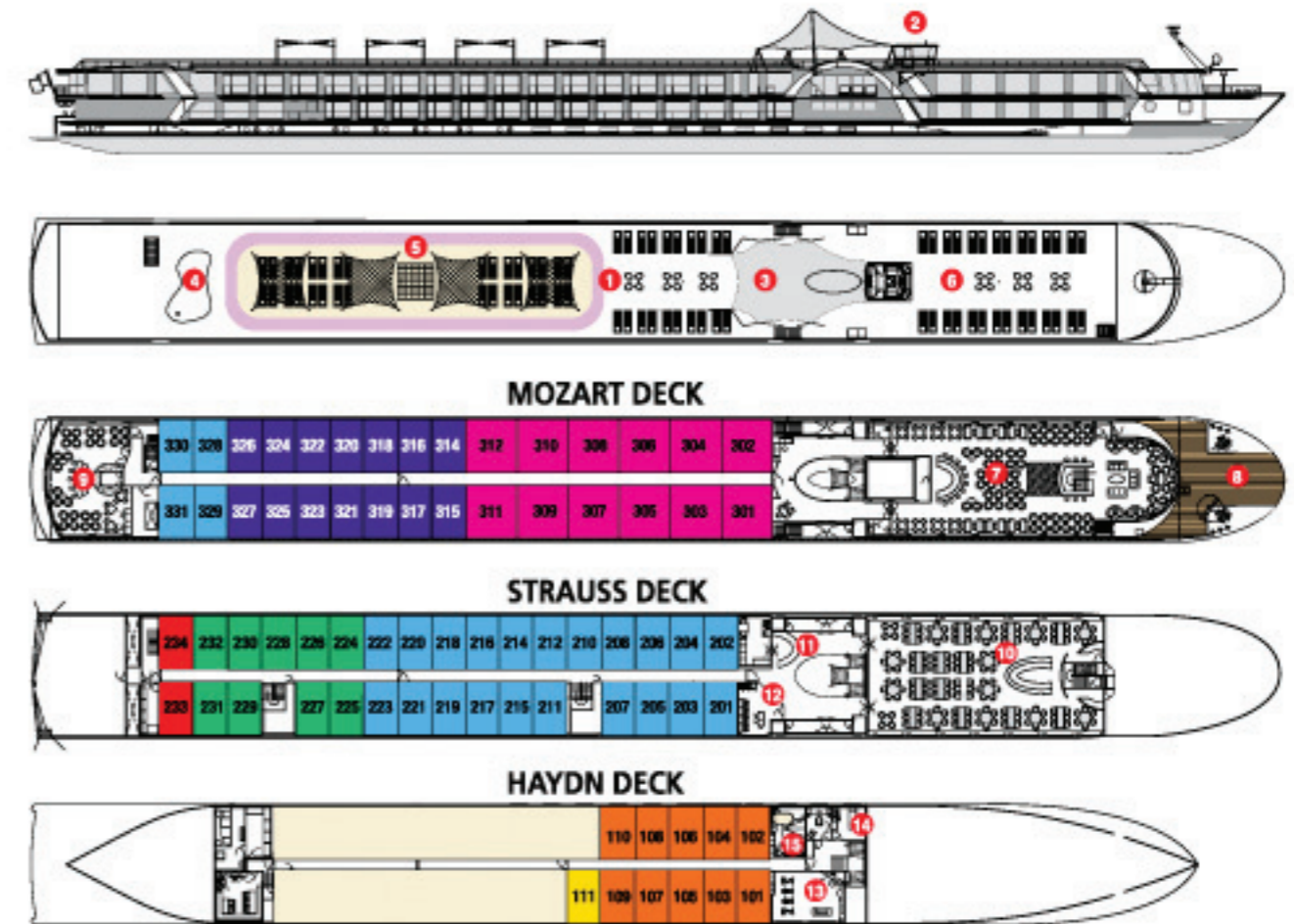
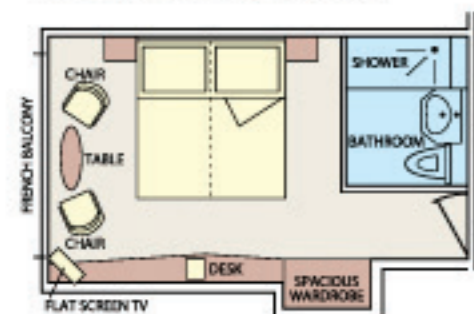

DECK PLAN

- 1 Sun Deck with Deck Chairs
- 2 Navigation Bridge
- 3 Lido Bar
- 4 Golf Putting Green
- 5 Walking Track
- 6 Shuffle-Board
- 7 Panorama Bar
- 8 Panorama Deck
- 9 Amadeus Club and Rear Deck
- 10 Panorama Restaurant
- 11 Reception
- 12 Gift Shop
- 13 Fitness Room
- 14 Massage
- 15 Hair Salon

CABIN CATEGORIES

- CAT S** Owner's Suite - Mozart Deck French Balcony - 22 sq m/236 sq ft
- CAT A** Mozart Deck French Balcony - 15 sq m/161 sq ft
- CAT B** Mozart Deck/Strauss Deck French Balcony - 15 sq m/161 sq ft
- CAT C** Strauss Deck French Balcony - 15 sq m/161 sq ft
- CAT CS** Strauss Deck French Balcony - 15 sq m/161 sq ft
- CAT E** Haydn Deck Standard Stateroom - 15 sq m/161 sq ft
- CAT ES** Haydn Deck Single Stateroom - 10 sq m/108 sq ft

TECHNICAL DATA

Launch March 2009 Draft 1,30 m Height 5,85 m Length 110 m
Width 11,40 m Speed 25 km/h Gross register tons 1,566 t
Crew members 41 Cabins/Suites 60/12 Passengers 143

Amadeus Elegant

Launching in April 2010

Identical to her Amadeus Diamond sister ship in construction, with the famous pointed bow, and measuring 110 m in length and 11.4 m in breadth the new flagship will fit in perfectly with the traditional elegance of the majestic Amadeus fleet. The vessel will accommodate up to 147 passengers in its extremely comfortable 67 cabins and 8 Amadeus suites. The bright, modern and inviting standard cabins have a floor area of 15 m² (161 sq.ft.), giving passengers a space of their own with all the accoutrements and pleasant touches of an ocean-going cruise liner. The stylishly furnished interiors include flat-screen TV, mini-bar, and designer bathroom accessories - matching the most modern hotel standards - with 80% of the cabins having magnificent panoramic windows and French balconies.



Luxury Owners Suites

For an extra touch of luxury and the ultimate in cruising indulgence, try one of our owners suites, with space rarely found on other ships. Measuring up to 236 sq.ft (22sq.m), the Owner's Suites represent the ultimate in spaciousness. The extra floor space is a benefit and it means that your Suite contains all the luxuries of a French Balcony stateroom and a lot more.



French Balcony Stateroom

Measuring up to 161 sq. ft (15sq.m), our all-weather French Balcony staterooms (83% of cabins) are located on the Strauss and Mozart Decks and offer exceptional comfort and the undeniable appeal of unimpeded views to the ever-changing landscapes of Europe.



Standard Stateroom

Measuring up to 161 sq. ft (15sq.m), the standard staterooms are located on the Haydn Deck. Though the cabin size and interior fixtures are identical to the French balcony stateroom, the difference is in the windows, as all Standard staterooms have fixed windows (do not open).

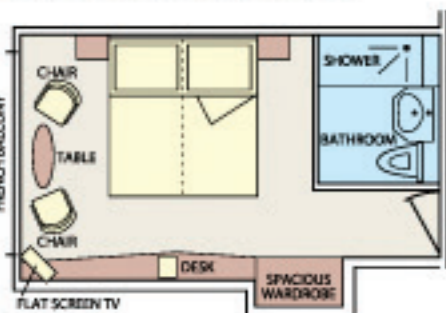

NOTE: Images and cabin layout taken from sister ship ms Amadeus Diamond as ms Amadeus Elegant is under construction.

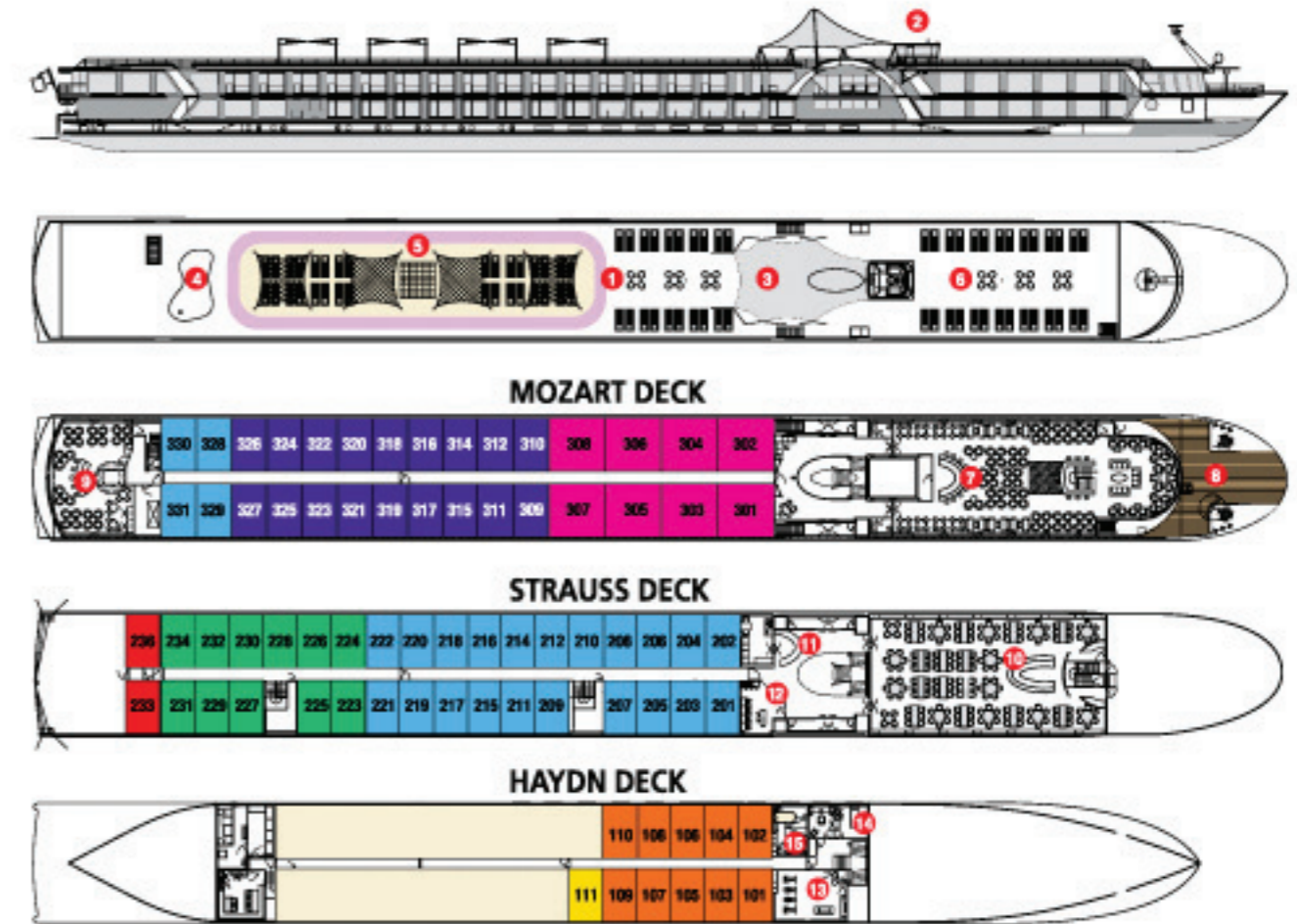
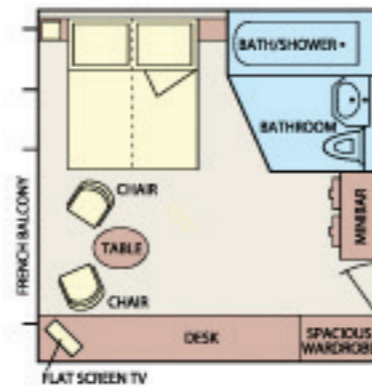

DECK PLAN

- 1 Sundeck with deck-chairs
- 2 Navigation bridge
- 3 Lido-Bar
- 4 Golf putting green
- 5 Giant chess
- 6 Shuffleboard
- 7 Panorama-Bar
- 8 Panorama-Deck
- 9 Amadeus-Club with Internet station
- 10 Panorama-Restaurant
- 11 Reception
- 12 Ship's shop
- 13 Fitness room
- 14 Massage
- 15 Hairdresser

CABIN CATEGORIES

- CAT S** Owner's Suite - Mozart Deck French Balcony - 22 sq m/236 sq ft
- CAT A** Mozart Deck French Balcony - 15 sq m/161 sq ft
- CAT B** Mozart Deck/Strauss Deck French Balcony - 15 sq m/161 sq ft
- CAT C** Strauss Deck French Balcony - 15 sq m/161 sq ft
- CAT CS** Strauss Deck Single French Balcony - 15 sq m/161 sq ft
- CAT E** Haydn Deck Standard Stateroom - 15 sq m/161 sq ft
- CAT ES** Haydn Deck Single Stateroom - 10 sq m/108 sq ft

TECHNICAL DATA

Launch Early 2010 Draft 1,30 m Height 5,85 m Length 110 m
Width 11,40 m Speed 25 km/h Gross register tons 1,566 t
Crew members 40 Cabins/Suites 68/8 Passengers 147